

**Figure 1**  
**Site Plan**



**SITE LEGEND**

- HEAVY DUTY ASPHALT PAVEMENT
  - REGULAR DUTY ASPHALT PAVEMENT
  - CONCRETE
  - STEEP SLOPE
  - 6' HIGH CHAIN LINK FENCE
- SEE SHEET C1 FOR ADDITIONAL LEGEND INFORMATION

**SITE DATA:**

ZONING:  
LOCAL JURISDICTION  
ZONING CLASSIFICATION (EXISTING)  
PERMITTED USES

**FLOOD ZONE CLASSIFICATION**

- (1) THE WAL-MART SUPERCENTER WILL REQUIRE A SPECIAL USE PERMIT FOR SIZE GREATER THAN 130,000 SF.
- (2) VARIANCES MAY BE REQUIRED FOR THE FOLLOWING: LOT WIDTH, FRONT YARD SETBACK, SIDE YARD SETBACK, GREENSPACE, LOT COVERAGE, PLANTING AISLES, TREES, BUILDING DESIGN, SITE LIGHTING, PARKING STALL SIZE, PARKING REQUIREMENT AND SIGNAGE. FOR ADDITIONAL INFORMATION, REFER TO THE TABLE BELOW AND/OR THE FEIS DOCUMENT.

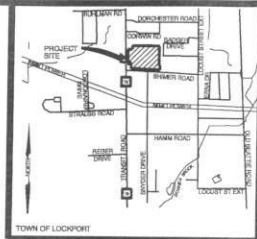

TOWN OF LOCKPORT, NY  
B-2 (BUSINESS) AND COMMERCIAL  
OVERLAY DISTRICT  
RETAIL (OVER 120,000 WILL REQUIRE  
A SPECIAL USE PERMIT)

**ZONEX X (OUTSIDE OF 500 YEAR FLOODPLAIN)**

(1) THE WAL-MART SUPERCENTER WILL REQUIRE A SPECIAL USE PERMIT FOR SIZE GREATER THAN 130,000 SF.  
(2) VARIANCES MAY BE REQUIRED FOR THE FOLLOWING: LOT WIDTH, FRONT YARD SETBACK, SIDE YARD SETBACK, GREENSPACE, LOT COVERAGE, PLANTING AISLES, TREES, BUILDING DESIGN, SITE LIGHTING, PARKING STALL SIZE, PARKING REQUIREMENT AND SIGNAGE. FOR ADDITIONAL INFORMATION, REFER TO THE TABLE BELOW AND/OR THE FEIS DOCUMENT.

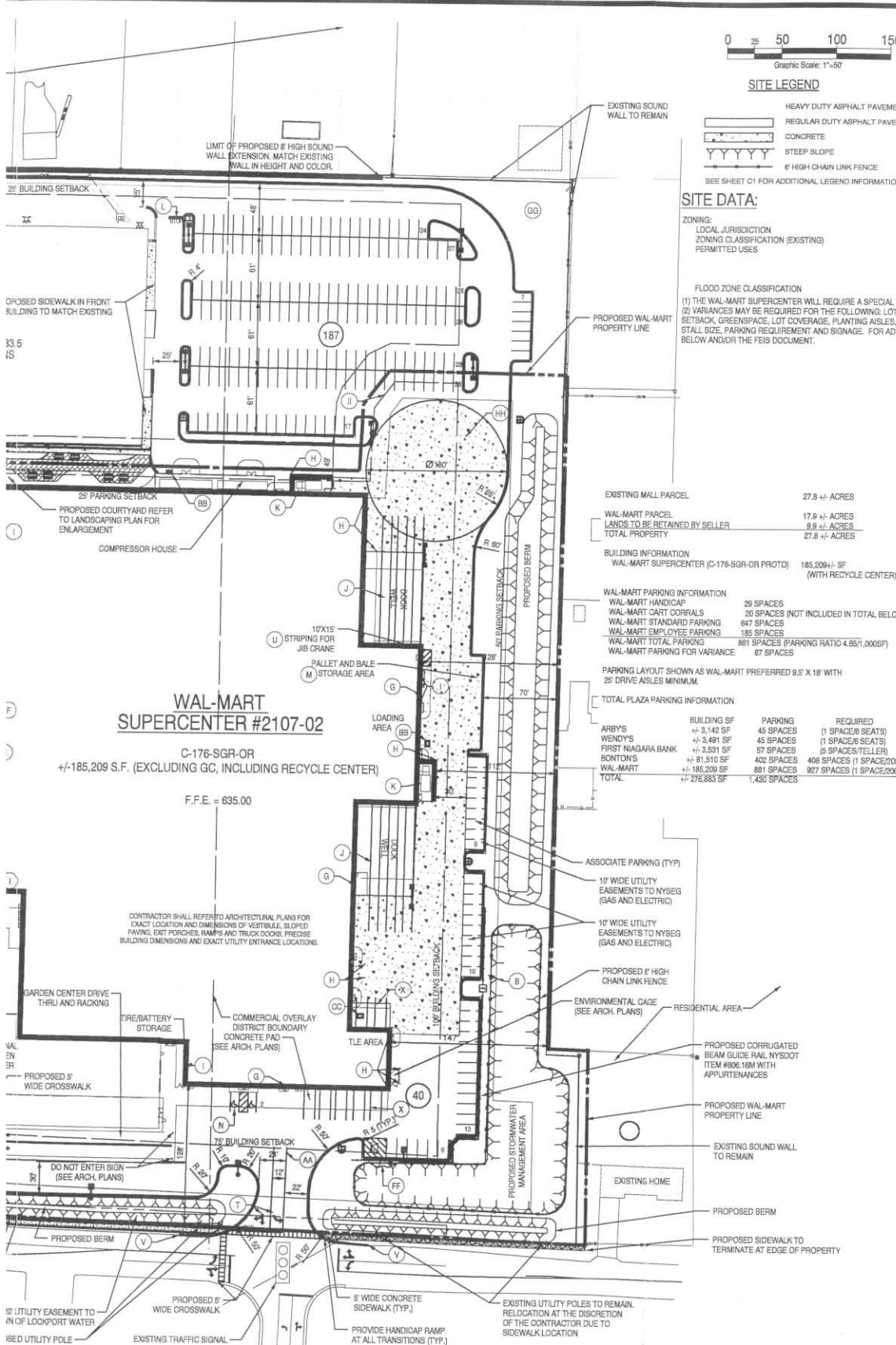

EXISTING MALL PARCEL 27.8 +/- ACRES

WAL-MART PARCEL 17.9 +/- ACRES

LANDS TO BE RETAINED BY SELLER 9.9 +/- ACRES

TOTAL PROPERTY 27.8 +/- ACRES

**BUILDING INFORMATION**  
WAL-MART SUPERCENTER (C-176-SGR-OR PROTO) 185,209 +/- SF (WITH RECYCLE CENTER)

**WAL-MART PARKING INFORMATION**

WAL-MART HANDICAP	29 SPACES
WAL-MART CART CORRALS	20 SPACES (NOT INCLUDED IN TOTAL BELOW)
WAL-MART STANDARD PARKING	647 SPACES
WAL-MART EMPLOYEE PARKING	185 SPACES
WAL-MART TOTAL PARKING	881 SPACES (PARKING RATIO 4.65/1,000SF)
WAL-MART PARKING FOR VARIANCE	87 SPACES

PARKING LAYOUT SHOWN AS WAL-MART PREFERRED 9.5' X 18' WITH 25' DRIVE AISLES MINIMUM.

**TOTAL PLAZA PARKING INFORMATION**

ARBY'S	BUILDING SF	PARKING	REQUIRED
WENDY'S	+/- 3,142 SF	45 SPACES	(1 SPACE/6 SEATS)
FIRST NIAGARA BANK	+/- 3,491 SF	45 SPACES	(1 SPACE/6 SEATS)
BONTONS	+/- 81,511 SF	402 SPACES	406 SPACES (1 SPACE/200 SF)
WAL-MART	+/- 185,209 SF	881 SPACES	927 SPACES (1 SPACE/200 SF)
TOTAL	+/- 276,353 SF	1,480 SPACES	

Revisions:	Date:	
1	REVISED BUILDING AND REMOVED GAS	04/16/05
2	REVISED FOR TOWN SUBMITTAL	05/18/05
3	REVISED NOTES AND	10/05/05
4	REVISED PER PDC COMMENTS	07/26/06
5	REVISED FOR PRELIMINARY SUBMITTAL TO WAL-MART	07/21/06
6	REVISED FOR DESIGN CIVIL SUBMISSION	08/16/06
7		
8		
9		

Seal	Seal
PROJECT MANAGER	DATE
PROJECT ENGINEER / ARCHITECT	DATE
PROJECT DESIGNER	DATE

Copyright © 2006  
Drawing Alteration  
It is a violation of law for any person, unless acting under the direction of a Licensed Professional Engineer, Landscape Architect, or Licensed Surveyor to alter any item on this document in any way.  
Any licensee who alters this document is required by law to affix his or her seal and to add the notation "Altered: 0/0" followed by the signature and the specific description of the alteration or revision.

**DO NOT SCALE PLANS**  
Copying, Printing, Scanning and other procedures required to produce these plans can distort or alter the actual paper or layout. Therefore, reading of the drawing may be inaccurate. Contact APD Engineering with any need for additional dimensions or clarifications.

**APD Engineering**  
3445 Winter Place - Suite 208  
Rochester, NY 14623  
585.273.0273  
585.273.0276 fax  
www.apd.com

**Wal-Mart Supercenter**  
#2107-02 - Lockport, NY  
5783 South Transit Road  
Town of Lockport  
Niagara County, NY

Project Name & Location:

**Site Plan**

Drawing Name:

Date: 3/19/04 Project No. 02-0006

Type: Drawn By: SGC C 3

Scale: 1" = 50' Drawing No.

- (L) "STOP" PAINTED ON PAVEMENT WITH SWSL24" STOP BAR-TYP AND SIGN POST. SEE DETAIL SHEET.
- (M) 12x90 BALE/PALLET STORAGE AREA. (REFER TO ARCH. PLANS FOR SCREENING DETAILS)
- (N) ACCESSIBLE PARKING SPACE TYPICAL. SEE DETAIL SHEET FOR ACCESSIBLE PARKING SPACE SIZE, SIGN AND SYMBOL. (VAN-INDICATES VAN ACCESSIBLE SPACE).
- (O) PAINTED ISLAND TYPICAL, UNLESS NOTED OTHERWISE. STRIPES SHALL BE PAINTED SYS14" AT 2'-0" O.C. PERPENDICULAR TO PARKING STRIPE.
- (P) PROPOSED RAMP LOCATIONS. REFER TO ARCH. PLANS FOR EXACT SIZE & LOCATION.
- (Q) CART CORRAL TYPICAL-SEE DETAIL SHEET FOR WAL-MART CART CORRAL DETAIL.
- (R) 8'-6" WIDE PARKING SPACE W/2'-0" LOADING ZONE AT ALL SPACES ADJACENT TO CURBS AND GUTTER - TYPICAL. 4" PAINTED YELLOW STRIPING @ 2'-0" O.C. PERPENDICULAR TO PARKING SPACE. SEE DETAIL SHEET.
- (S) 18" CONCRETE CURB AND GUTTER - TYPICAL. SEE DETAIL SHEET. SEE PLAN FOR TYPE (TYPE "M" - STANDARD, TYPE "B" - INTEGRAL).
- (T) PAINTED DIRECTIONAL ARROW TYPICAL. SEE DETAIL SHEET.
- (U) STRIPED AREA PAINTED SYS14" AT 45 DEGREES @ 2'-0" O.C. AT JIB CRANE LOCATION. SEE ARCH. PLANS.
- (V) PROVIDE TRANSITION CURB AND MATCH EXISTING GRADE AND ALIGNMENT.
- (W) AISLE INDICATOR SIGNS TYPICAL - SEE DETAIL SHEET.
- (X) TLE STRIPING SYS14" - SEE DETAIL SHEET.
- (Y) "NO TRUCKS" SIGN. SEE DETAIL SHEET.
- (Z) TRUCK ROUTE SIGN- SEE DETAIL SHEET.
- (AA) DOUBLE YELLOW STRIPING.
- (BB) GREASE INTERCEPTOR. REFER TO ARCHITECTURAL/MEP PLANS.
- (CC) OIL INTERCEPTOR. REFER TO ARCHITECTURAL/MEP PLANS.
- (DD) 5.0' WIDE CART CROSSING AREA TO BE STRIPED 4" TRAFFIC YELLOW, 2'-0" O.C. LOCATE (R) CART CROSSING SIGNS WITH IN ISLAND FACING OUT.
- (EE) NO PARKING FIRE LANE SIGN.
- (FF) 8' WIDE DOUBLE GATE. CURBING TO HAVE 3" REVEAL DIRECTLY IN FRONT OF GATE, AND GUIDERAIL TO TERMINATE IN FRONT OF GATE OPENING.
- (GG) SNOW STORAGE AREA.
- (HH) CONCRETE JOINTING AND FILLERS TO BE COMPLETED PER DETAIL (TYPICAL OF ALL EXTERIOR CONCRETE EXCLUSIVE OF ARCHITECTURAL CONCRETE).
- (II) BUILDING SETBACK LINE PER ZONING ORDINANCE.

- (J) REID WITH "NO PARKING FIRE LANE" PAINTED WITH 4" DETAIL SHEET.
- (K) FOR ADDITIONAL INFORMATION.
- (L) WHITE STRIPING PARALLEL TO DIRECTION OF PERPENDICULAR ON BOTH ENDS UNLESS NOTED VYOND VESTIBULE LIMITS
- (M) TYPICAL AT PEDESTRIAN CROSSWALKS AS NOTED ON PLANS.
- (N) TYPICAL. SEE DETAIL SHEET.
- (O) BE FLUSH WITH TOP OF SIDEWALK
- (P) KACT SIZE LOCATION FOR STOPS, STAIRS, AND/OR TYPICAL. SEE DETAIL SHEET.
- (Q) SEE DETAIL SHEET.
- (R) ARCHITECTURAL PLANS FOR EXACT SIZE AND LOCATION.
- (S) TRUCK ALIGNMENT STRIPES SPACED 10' O.C.
- (T) TRUCK ALIGNMENT.
- (U) SLOPE, COMPACTOR

**Figure 2**  
**Lighting Plan**



**LIGHTING SCHEDULE**

POLE #	BASE	POLE	FIXTURE	NOTES
L1	NEW	NEW	BV	
L2	NEW	NEW	BV	
L3	NEW	NEW	BV	
L4	NEW	NEW	BV	
L5	NEW	NEW	BV	
L6	NEW	NEW	BV	
L7	NEW	NEW	KV	
L8	NEW	NEW	KV	
L9	NEW	NEW	BV	
L10	NEW	NEW	BV	SEE NOTE 4
L11	NEW	NEW	BV	
L12	NEW	NEW	BV	SEE NOTE 4
L13	NEW	NEW	KV	
L14	NEW	NEW	BV	
L15	NEW	NEW	BV	
L16	NEW	NEW	BV	
L17	NEW	NEW	BV	
L18	NEW	NEW	KV	
L19	NEW	NEW	KV	
L20	NEW	NEW	BV	
L21	NEW	NEW	BV	
L22	NEW	NEW	BV	
L23	NEW	NEW	BV	
L24	NEW	NEW	BV	SEE NOTE 2
L25	NEW	NEW	BV	SEE NOTE 2
L26	NEW	NEW	BV	SEE NOTE 2
L27	NEW	NEW	BV	SEE NOTE 2
L28	NEW	NEW	BV	SEE NOTE 2
L29	NEW	NEW	BV	SEE NOTE 2
L30	NEW	NEW	BV	SEE NOTE 2
L31	NEW	NEW	BV	SEE NOTE 2
L32	NEW	NEW	BV	
L33	NEW	NEW	BV1	
L34	NEW	NEW	BV1	
L35	NEW	NEW	FV	
L36	NEW	NEW	FV	
L37	NEW	NEW	FV	
L38	NEW	NEW	FV	
L39	NEW	NEW	FV	
L40	NEW	NEW	FV	
L41	NEW	NEW	FV	

**NOTES:**

- REFER TO THE ARCHITECTURAL PLANS FOR SITE LIGHTING ELECTRICAL DESIGN AND LAYOUT.
- LIGHTS WITHIN BONTON PROPERTY SHALL BE WIRED TO THE EXISTING BONTON STORE.
- ALL NEW LIGHT POLES AND ALL FIXTURES WILL BE SUPPLIED BY LSI LIGHTING (ATTN: CHERI KEFFER), 10000 ALLIANCE ROAD, CINCINNATI, OH 45242, (800) 436-7800 X 3211.
- THERE ARE 2 LIGHT POLES WITHIN THE FRONT PARKING LOT THAT ARE TO RECEIVE LOSS PREVENTION CAMERAS.
- PYLON SIGN SHALL BE CONSTRUCTED BY OTHERS.
- LIGHT POLES ADJACENT TO DRIVES SHALL BE PLACED SO THAT THE OUTSIDE EDGE OF CONCRETE BASE IS 3' FROM BACK OF CURB.

Revisions:	Date:
1	
2	
3	
4	
5	
6	
7	
8	
9	

Seal	Seal
PROJECT MANAGER	DATE
PROJECT ENGINEER / ARCHITECT	DATE
PROJECT DESIGNER	DATE

Copyright © 2006  
Drawing Alteration  
It is a violation of law for any person, unless acting under the direction of licensed Architect, Professional Engineer, Landscape Architect, or Land Surveyor to alter any item on this document in any way.  
Any licensee who alters this document is required by law to affix his or her seal and to add the notation "Altered By" followed by his or her signature and the specific description of the alteration or revision.  
**DO NOT SCALE PLANS**  
Copying, Printing, Software and other processes required to produce these prints can stretch or skew the actual paper or layout. Therefore, scaling of the drawing may be inaccurate. Contact APD Engineering with any need for additional dimensions or clarifications.

**APD Engineering**  
3445 Winton Place - Suite 208  
Rochester, NY 14623  
585.273.0273  
585.273.0276 fax  
www.apd.com

**Wal-Mart Supercenter**  
#2107-02 - Lockport, NY  
5783 South Transit Road  
Town of Lockport  
Niagara County, NY  
Project Name & Location:

**Lighting Plan**

Drawing Name: \_\_\_\_\_

Date: 3/19/04      Project No. 02-0006

Type: \_\_\_\_\_

Drawn By: SLB      C7

Scale: 1" = 50'      Drawing No. \_\_\_\_\_

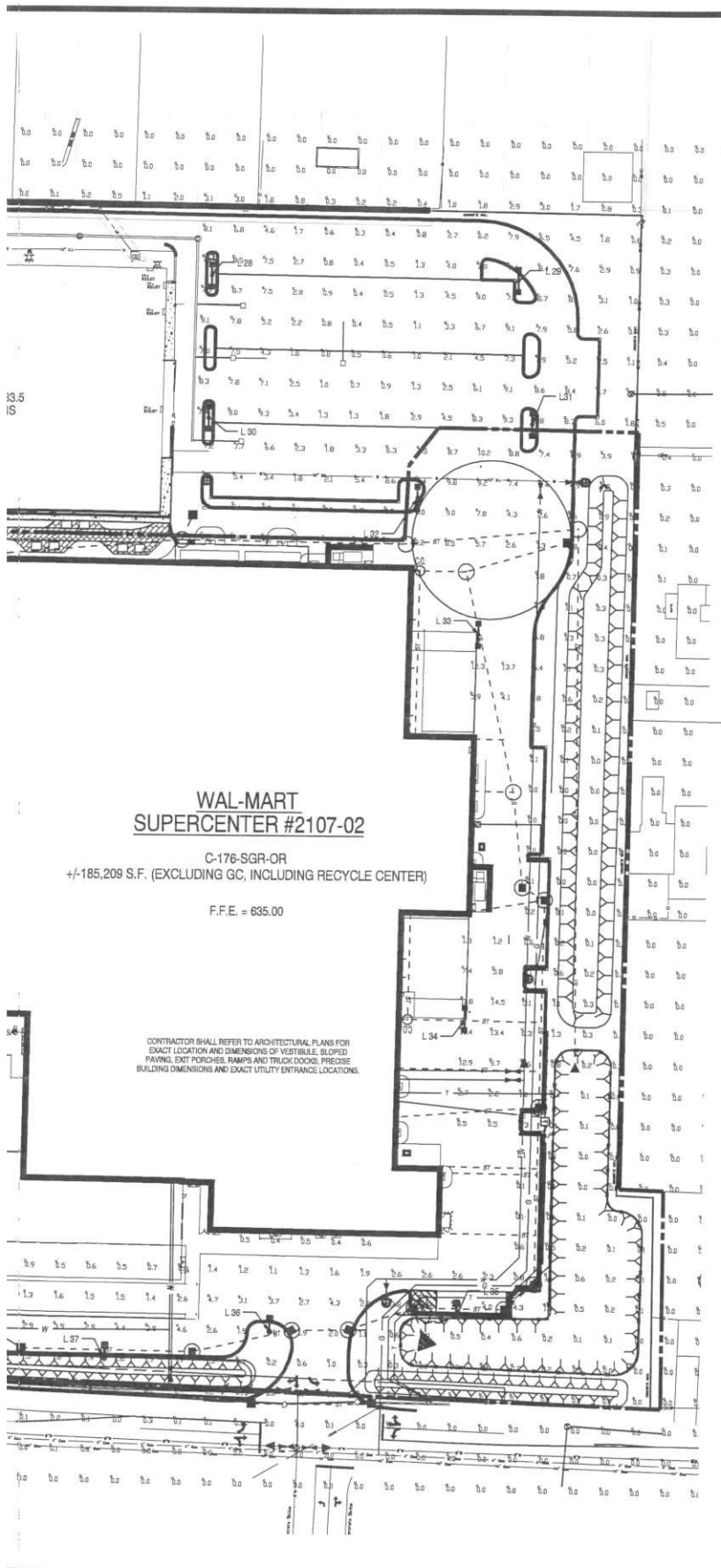

**WAL-MART  
SUPERCENTER #2107-02**

C-176-SGR-OR  
+/-185,209 S.F. (EXCLUDING GC, INCLUDING RECYCLE CENTER)

F.F.E. = 635.00

CONTRACTOR SHALL REFER TO ARCHITECTURAL PLANS FOR EXACT LOCATION AND DIMENSIONS OF VESTIBULE, SLOPED PAVING, EXIT PORCHES, RAMPS AND TRUCK DOCKS, PRECISE BUILDING DIMENSIONS AND EXACT UTILITY ENTRANCE LOCATIONS.

Arrangement	Lumens	LLF	Description
SINGLE	120000	0.750	GFRS-2-1000-PSMH-F-3HSS 27' POLE 3' BASE
D180	120000	0.750	GFRS-5-1000-PSMH-F 27' POLE 3' BASE
3 @ 90 DEGREES	120000	0.750	GFRS-5-1000-PSMH-F 27' POLE 3' BASE
D180	120000	0.750	GFRS-5-1000-PSMH-F 20' POLE 3' BASE

**Statistical Area Summary**

Label	Avg	Max	Min	Avg/Min	Max/Min
FRONT DRIVE SUMMARY	10.52	14.7	2.7	3.90	5.44
MAIN LOT SUMMARY	5.74	13.0	1.2	4.78	10.83

**Figure 3**  
**Landscaping Plan**



**Figure 4**  
**Grading and Drainage Plan**

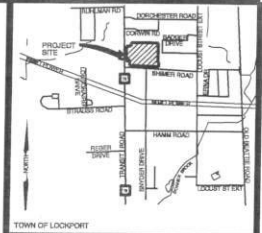
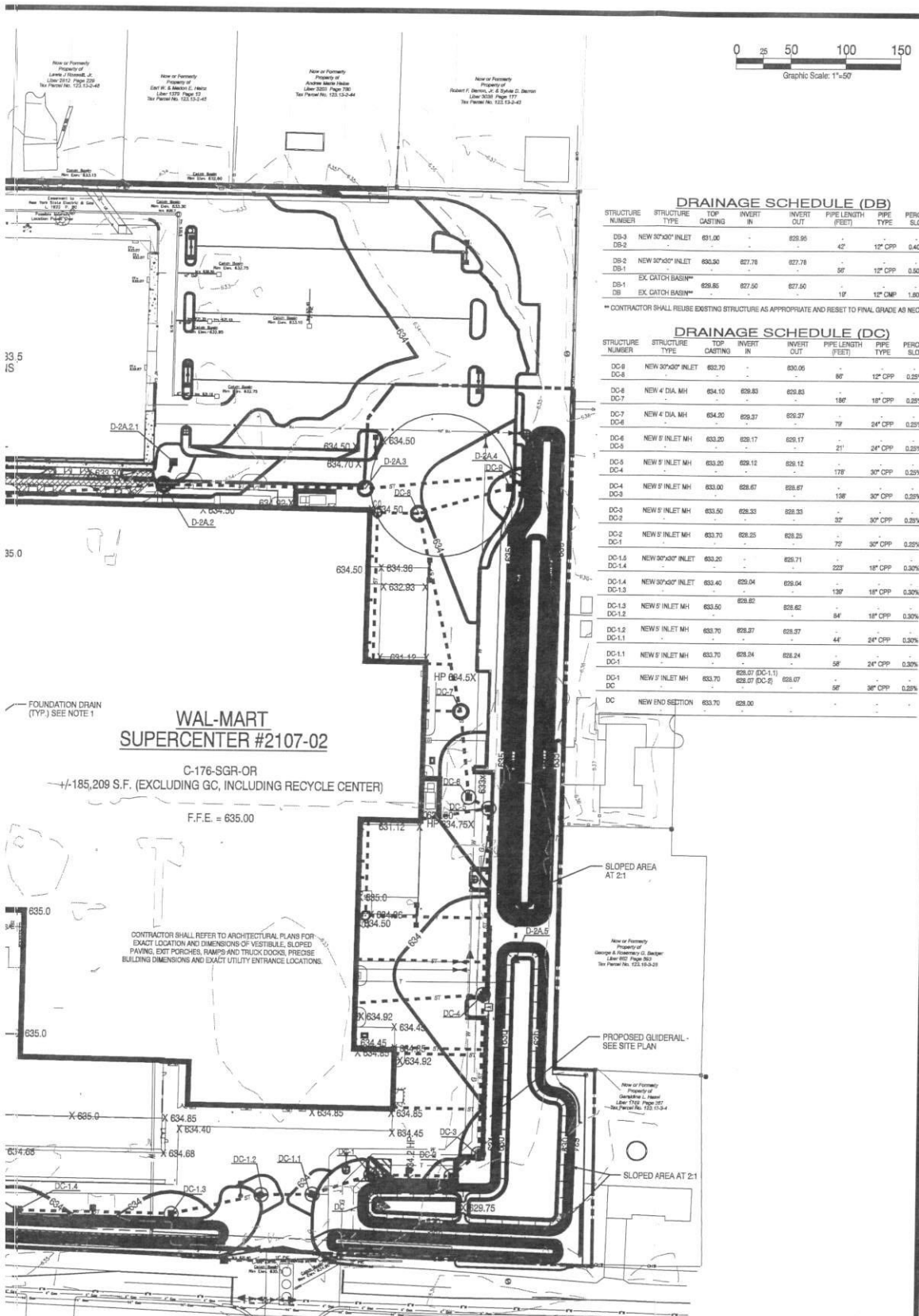

LOCATION SKETCH  
N.T.S.

**DRAINAGE SCHEDULE (DB)**

STRUCTURE NUMBER	STRUCTURE TYPE	TOP CASTING	INVERT IN	INVERT OUT	PIPE LENGTH (FEET)	PIPE TYPE	PERCENT SLOPE
DB-3	NEW 30"x30" INLET	631.00	-	629.95	42'	12" CPP	0.40%
DB-2	NEW 30"x30" INLET	630.30	627.78	627.78	58'	12" CPP	0.50%
DB-1	EX CATCH BASIN**	628.85	627.50	627.50	19'	12" CMP	1.80%

\*\* CONTRACTOR SHALL REUSE EXISTING STRUCTURE AS APPROPRIATE AND RESET TO FINAL GRADE AS NECESSARY

**DRAINAGE SCHEDULE (DC)**

STRUCTURE NUMBER	STRUCTURE TYPE	TOP CASTING	INVERT IN	INVERT OUT	PIPE LENGTH (FEET)	PIPE TYPE	PERCENT SLOPE
DC-8	NEW 30"x30" INLET	633.70	-	630.06	89'	12" CPP	0.25%
DC-6	NEW 4" DIA. MH	634.10	629.85	629.85	186'	18" CPP	0.25%
DC-7	NEW 4" DIA. MH	634.30	629.37	629.37	79'	24" CPP	0.25%
DC-4	NEW 8" INLET MH	633.20	628.17	628.17	21'	34" CPP	0.25%
DC-5	NEW 9" INLET MH	633.20	628.12	628.12	178'	30" CPP	0.25%
DC-4	NEW 9" INLET MH	633.00	628.07	628.07	138'	30" CPP	0.25%
DC-3	NEW 9" INLET MH	633.50	628.33	628.33	32'	30" CPP	0.25%
DC-2	NEW 9" INLET MH	633.70	628.25	628.25	72'	30" CPP	0.25%
DC-1.5	NEW 30"x30" INLET	633.20	-	628.71	223'	18" CPP	0.30%
DC-1.4	NEW 30"x30" INLET	633.40	629.04	629.04	139'	18" CPP	0.30%
DC-1.3	NEW 9" INLET MH	633.50	628.82	628.82	84'	18" CPP	0.30%
DC-1.2	NEW 9" INLET MH	633.70	628.37	628.37	44'	24" CPP	0.30%
DC-1.1	NEW 9" INLET MH	633.70	628.24	628.24	58'	24" CPP	0.30%
DC-1	NEW 9" INLET MH	633.70	628.07 (DC-1.1) 628.07 (DC-2)	628.07	56'	38" CPP	0.25%
DC	NEW END SECTION	633.70	628.00	-	-	-	-



**WAL-MART  
SUPERCENTER #2107-02**

C-176-SGR-OR  
±185,209 S.F. (EXCLUDING GC, INCLUDING RECYCLE CENTER)  
F.F.E. = 635.00

Revisions:	Date:
1 REVISED BUILDING SIZE	04/05
2 REVISED PER TOWN SUBMITTAL	05/05
3 REVISED FOR PRELIMINARY SUBMITTAL TO WAL-MART	07/06
4 REVISED FOR DESIGN CIVIL SUBMISSION	08/06
5	
6	
7	
8	
9	

Seal	Seal	DATE
PROJECT MANAGER		
PROJECT ENGINEER / ARCHITECT		
PROJECT DESIGNER		

Copyright © 2006  
APD Engineering  
Drawing Attention  
It is a violation of law for any person, unless acting under the direction of a licensed Professional Engineer, Landscape Architect, or Licensed Surveyor to alter any item on this document in any way.  
Any licensee who alters this document is required by law to affix his or her seal and to add the notation "Altered By" followed by the licor's signature and the specific description of the alteration or revision.

**APD Engineering**  
3445 Winton Place - Suite 208  
Rochester, NY 14623  
585.273.0273  
585.273.0276 fax  
www.apd.com

**Wal-Mart Supercenter**  
#2107-02 - Lockport, NY  
5783 South Transit Road  
Town of Lockport  
Niagara County, NY  
Project Name & Location:

**GRADING & DRAINAGE PLAN**

Drawing Name:

Date: 3/19/04	Project No.
Type:	02-0006
Drawn By: SLB	C 4
Scale: 1" = 50'	Drawing No.

**SE SCHEDULE**

INVERT IN	INVERT OUT	PIPE LENGTH (FEET)	PIPE TYPE	PERCENT SLOPE
626.14	-	47'	12" CPP	0.3%
626.02 (D-1.1)	626.02	81'	36" ARCH	0.4%
626.10 (D-1A)	-	-	-	-
626.70	-	-	-	-

**DRAINAGE SCHEDULE (DA)**

STRUCTURE NUMBER	STRUCTURE TYPE	TOP CASTING	INVERT IN	INVERT OUT	PIPE LENGTH (FEET)	PIPE TYPE	PERCENT SLOPE
DA-2D	NEW 30"x30" INLET	631.40	-	627.80	72'	12" CPP	0.40%
DA-2C	NEW 30"x30" INLET	631.10	-	627.87	244'	12" CPP	0.40%
DA-2B	NEW 4" INLET MH	632.50	-	628.23	228'	34" CMP	0.50%
DA-2A.1	NEW 30"x30" INLET	631.80	-	627.59	19'	12" CPP	0.47%
DA-2A	NEW 30"x30" INLET	631.80	627.51	627.51	139'	12" CPP	0.40%
DA-2	EX. INLET MANHOLE**	627.51 (DA-2B) 627.00 (DA-2C) 626.86 (DA-2D) 627.00 (DA-2A)	627.00	627.00	72'	34" CMP	0.40%
DA-1.1	NEW 30"x30" INLET	631.00	-	626.86	37'	12" CPP	0.47%
DA-1	NEW 4" DIA. MH	629.85	626.71 (DA-1.1) 626.71 (DA-2)	626.71	227'	24" CMP	0.45%
D	EX. CATCH BASIN**	628.85	625.60	625.71	227'	24" CMP	0.45%

\*\* RESET TO FINAL GRADE  
\*\* CONTRACTOR SHALL REUSE EXISTING STRUCTURE AS APPROPRIATE AND RESET TO FINAL GRADE AS NECESSARY

**Figure 5**  
**Utility Plan**